

RECEIVED
 AUG 14 2024
 By _____

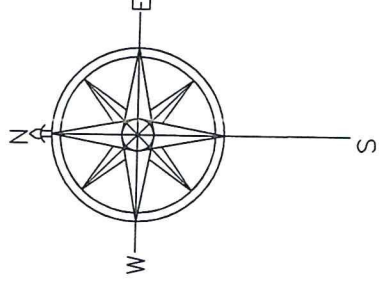

◇ = R/W Marker

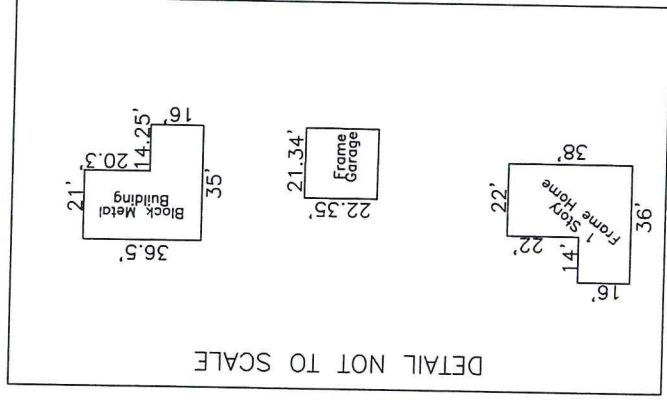

NW. COR. NW. QTR.
 EXISTING 5/8" REBAR
 REF. AT COUNTY
 SURVEYOR'S OFFICE

NE. COR. W. 1/2 NW. QTR.
 SEC. 8-19-9
 BY ALIQUOT DIVISION

EXISTING 1" HOLLOW PIN
 NE. COR. NW. QTR.
 SEC. 08-19-09
 REF. AT COUNTY SURVEYOR'S OFFICE

COUNTY ROAD 500 S.
 N 89°28'47" E 1308.09'

NE. COR. W. 1/2 NW. QTR.
 SEC. 8-19-9
 BY ALIQUOT DIVISION

EXISTING 1" HOLLOW PIN
 NE. COR. NW. QTR.
 SEC. 08-19-09
 REF. AT COUNTY SURVEYOR'S OFFICE

SW. COR. NW. QTR.
 SEC. 08-19-09
 BY ALIQUOT DIVISION

NE. COR. W. 1/2 NW. QTR.
 SEC. 8-19-9
 BY ALIQUOT DIVISION

EXISTING 1" HOLLOW PIN
 NE. COR. NW. QTR.
 SEC. 08-19-09
 REF. AT COUNTY SURVEYOR'S OFFICE

SE. COR. NE. QTR. NW. QTR.
 SEC. 8-19-9
 BY ALIQUOT DIVISION

NE. COR. W. 1/2 NW. QTR.
 SEC. 8-19-9
 BY ALIQUOT DIVISION

EXISTING 1" HOLLOW PIN
 NE. COR. NW. QTR.
 SEC. 08-19-09
 REF. AT COUNTY SURVEYOR'S OFFICE

SW. COR. NW. QTR.
 SEC. 08-19-09
 BY ALIQUOT DIVISION

NE. COR. W. 1/2 NW. QTR.
 SEC. 8-19-9
 BY ALIQUOT DIVISION

EXISTING 1" HOLLOW PIN
 NE. COR. NW. QTR.
 SEC. 08-19-09
 REF. AT COUNTY SURVEYOR'S OFFICE

SE. COR. NE. QTR. NW. QTR.
 SEC. 8-19-9
 BY ALIQUOT DIVISION

NE. COR. W. 1/2 NW. QTR.
 SEC. 8-19-9
 BY ALIQUOT DIVISION

EXISTING 1" HOLLOW PIN
 NE. COR. NW. QTR.
 SEC. 08-19-09
 REF. AT COUNTY SURVEYOR'S OFFICE

SW. COR. NW. QTR.
 SEC. 08-19-09
 BY ALIQUOT DIVISION

NE. COR. W. 1/2 NW. QTR.
 SEC. 8-19-9
 BY ALIQUOT DIVISION

EXISTING 1" HOLLOW PIN
 NE. COR. NW. QTR.
 SEC. 08-19-09
 REF. AT COUNTY SURVEYOR'S OFFICE

SE. COR. NE. QTR. NW. QTR.
 SEC. 8-19-9
 BY ALIQUOT DIVISION

NE. COR. W. 1/2 NW. QTR.
 SEC. 8-19-9
 BY ALIQUOT DIVISION

EXISTING 1" HOLLOW PIN
 NE. COR. NW. QTR.
 SEC. 08-19-09
 REF. AT COUNTY SURVEYOR'S OFFICE

SW. COR. NW. QTR.
 SEC. 08-19-09
 BY ALIQUOT DIVISION

NE. COR. W. 1/2 NW. QTR.
 SEC. 8-19-9
 BY ALIQUOT DIVISION

EXISTING 1" HOLLOW PIN
 NE. COR. NW. QTR.
 SEC. 08-19-09
 REF. AT COUNTY SURVEYOR'S OFFICE

SE. COR. NE. QTR. NW. QTR.
 SEC. 8-19-9
 BY ALIQUOT DIVISION

NE. COR. W. 1/2 NW. QTR.
 SEC. 8-19-9
 BY ALIQUOT DIVISION

EXISTING 1" HOLLOW PIN
 NE. COR. NW. QTR.
 SEC. 08-19-09
 REF. AT COUNTY SURVEYOR'S OFFICE

SW. COR. NW. QTR.
 SEC. 08-19-09
 BY ALIQUOT DIVISION

NE. COR. W. 1/2 NW. QTR.
 SEC. 8-19-9
 BY ALIQUOT DIVISION

EXISTING 1" HOLLOW PIN
 NE. COR. NW. QTR.
 SEC. 08-19-09
 REF. AT COUNTY SURVEYOR'S OFFICE

SE. COR. NE. QTR. NW. QTR.
 SEC. 8-19-9
 BY ALIQUOT DIVISION

NE. COR. W. 1/2 NW. QTR.
 SEC. 8-19-9
 BY ALIQUOT DIVISION

EXISTING 1" HOLLOW PIN
 NE. COR. NW. QTR.
 SEC. 08-19-09
 REF. AT COUNTY SURVEYOR'S OFFICE

SW. COR. NW. QTR.
 SEC. 08-19-09
 BY ALIQUOT DIVISION

NE. COR. W. 1/2 NW. QTR.
 SEC. 8-19-9
 BY ALIQUOT DIVISION

EXISTING 1" HOLLOW PIN
 NE. COR. NW. QTR.
 SEC. 08-19-09
 REF. AT COUNTY SURVEYOR'S OFFICE

SE. COR. NE. QTR. NW. QTR.
 SEC. 8-19-9
 BY ALIQUOT DIVISION

NE. COR. W. 1/2 NW. QTR.
 SEC. 8-19-9
 BY ALIQUOT DIVISION

EXISTING 1" HOLLOW PIN
 NE. COR. NW. QTR.
 SEC. 08-19-09
 REF. AT COUNTY SURVEYOR'S OFFICE

SW. COR. NW. QTR.
 SEC. 08-19-09
 BY ALIQUOT DIVISION

NE. COR. W. 1/2 NW. QTR.
 SEC. 8-19-9
 BY ALIQUOT DIVISION

EXISTING 1" HOLLOW PIN
 NE. COR. NW. QTR.
 SEC. 08-19-09
 REF. AT COUNTY SURVEYOR'S OFFICE

SE. COR. NE. QTR. NW. QTR.
 SEC. 8-19-9
 BY ALIQUOT DIVISION

NE. COR. W. 1/2 NW. QTR.
 SEC. 8-19-9
 BY ALIQUOT DIVISION

EXISTING 1" HOLLOW PIN
 NE. COR. NW. QTR.
 SEC. 08-19-09
 REF. AT COUNTY SURVEYOR'S OFFICE

SW. COR. NW. QTR.
 SEC. 08-19-09
 BY ALIQUOT DIVISION

NE. COR. W. 1/2 NW. QTR.
 SEC. 8-19-9
 BY ALIQUOT DIVISION

EXISTING 1" HOLLOW PIN
 NE. COR. NW. QTR.
 SEC. 08-19-09
 REF. AT COUNTY SURVEYOR'S OFFICE

SE. COR. NE. QTR. NW. QTR.
 SEC. 8-19-9
 BY ALIQUOT DIVISION

NE. COR. W. 1/2 NW. QTR.
 SEC. 8-19-9
 BY ALIQUOT DIVISION

EXISTING 1" HOLLOW PIN
 NE. COR. NW. QTR.
 SEC. 08-19-09
 REF. AT COUNTY SURVEYOR'S OFFICE

SW. COR. NW. QTR.
 SEC. 08-19-09
 BY ALIQUOT DIVISION

NE. COR. W. 1/2 NW. QTR.
 SEC. 8-19-9
 BY ALIQUOT DIVISION

EXISTING 1" HOLLOW PIN
 NE. COR. NW. QTR.
 SEC. 08-19-09
 REF. AT COUNTY SURVEYOR'S OFFICE

SE. COR. NE. QTR. NW. QTR.
 SEC. 8-19-9
 BY ALIQUOT DIVISION

NE. COR. W. 1/2 NW. QTR.
 SEC. 8-19-9
 BY ALIQUOT DIVISION

EXISTING 1" HOLLOW PIN
 NE. COR. NW. QTR.
 SEC. 08-19-09
 REF. AT COUNTY SURVEYOR'S OFFICE

SW. COR. NW. QTR.
 SEC. 08-19-09
 BY ALIQUOT DIVISION

NE. COR. W. 1/2 NW. QTR.
 SEC. 8-19-9
 BY ALIQUOT DIVISION

EXISTING 1" HOLLOW PIN
 NE. COR. NW. QTR.
 SEC. 08-19-09
 REF. AT COUNTY SURVEYOR'S OFFICE

SE. COR. NE. QTR. NW. QTR.
 SEC. 8-19-9
 BY ALIQUOT DIVISION

NE. COR. W. 1/2 NW. QTR.
 SEC. 8-19-9
 BY ALIQUOT DIVISION

EXISTING 1" HOLLOW PIN
 NE. COR. NW. QTR.
 SEC. 08-19-09
 REF. AT COUNTY SURVEYOR'S OFFICE

SW. COR. NW. QTR.
 SEC. 08-19-09
 BY ALIQUOT DIVISION

NE. COR. W. 1/2 NW. QTR.
 SEC. 8-19-9
 BY ALIQUOT DIVISION

EXISTING 1" HOLLOW PIN
 NE. COR. NW. QTR.
 SEC. 08-19-09
 REF. AT COUNTY SURVEYOR'S OFFICE

SE. COR. NE. QTR. NW. QTR.
 SEC. 8-19-9
 BY ALIQUOT DIVISION

NE. COR. W. 1/2 NW. QTR.
 SEC. 8-19-9
 BY ALIQUOT DIVISION

EXISTING 1" HOLLOW PIN
 NE. COR. NW. QTR.
 SEC. 08-19-09
 REF. AT COUNTY SURVEYOR'S OFFICE

This Instrument Prepared by: Haldon L. Ashton
 Accuracy or completeness of subsurface features is not certified.

Revisions	
Date:	
Reason:	
Date:	
Reason:	
Drawn: SMK	
Date: 07/02/24	
Job: 2024228 A	
Client: Dan & Karen Ashton	
Owner: Dan & Karen Ashton	
Crew: EA	
Electronic Field Book	

REZONING SHEET
 STATE ROAD #67
 DALEVILLE, IN

SECTION CORNER COORDINATES ARE BASED ON
 INDIANA STATE PLANE EAST ZONE (NORTH AMERICAN
 DATUM OF 1983, CORRS 96 EPOC 2002.000)

I, AFFIRM, UNDER THE PENALTIES FOR PERJURY, THAT I HAVE TAKEN
 REASONABLE CARE TO REDACT EACH SOCIAL SECURITY NUMBER IN THIS
 DOCUMENT, UNLESS REQUIRED BY LAW (HALDON L. ASHTON).



325 West Washington Street Muncie, IN 47305
 Ph: (765)282-5594 Fax: (765)282-5594
 Email: ashtonlandsurveyors.com

RECEIVED

AUG 14 2024

By _____

Tract 1 (R1 Zoning to F Zoning)

A part of the West Half of the West Half of the Northwest Quarter of Section 8, Township 19 North, Range 9 East in Salem Township, Delaware County, Indiana, described as follows:

Beginning at a point on the West line of the West Half of the Northwest Quarter of Section 8, Township 19 North, Range 9 East, said point being North 00 degrees 00 minutes 55 seconds East 507.18 feet (assumed bearing) from a mag nail marking the Southwest corner of said Half-Half-Quarter Section; thence North 00 degrees 00 minutes 55 seconds East 89.40 feet; thence South 88 degrees 40 minutes 47 seconds East 659.01 feet to the East line of said Half-Half-Quarter Section; thence South 00 degrees 01 minutes 05 seconds West 476.84 feet along said East line to the Northerly right-of-way line of State Highway #67; thence North 83 degrees 54 minutes 35 seconds West 268.78 feet along said right-of-way line to a point; thence North 00 degrees 00 minutes 55 seconds East 378.77 feet along a line parallel with the West line of said Half-Half-Quarter Section; thence South 89 degrees 19 minutes 06 seconds West 391.58 feet parallel with the South line of said Half-Half-Quarter Section to the point of beginning, containing 3.60 acres, more or less.

Tract 2 (BV Zoning to F Zoning)

A part of the East Half of the West Half of the Northwest Quarter of Section 8, Township 19 North, Range 9 East in Salem Township, Delaware County, Indiana, described as follows:

Commencing at the Southeast corner of the East Half of the West Half of the Northwest Quarter of Section 8, Township 19 North, Range 9 East; thence South 89 degrees 19 minutes 06 seconds West 649.01 feet (assumed bearing) along the South line of said Half-Half-Quarter Section to the Southwest corner thereof; thence North 00 degrees 01 minutes 05 seconds East 428.46 feet along the West line of said Half-Half-Quarter Section to the point of beginning at the center of the Shoemaker Regulated Drain; thence North 00 degrees 01 minutes 05 seconds East 568.87 feet; thence North 89 degrees 53 minutes 57 seconds East 253.68 feet; thence South 00 degrees 36 minutes 18 seconds East 399.30 feet to the center of said drain; thence South 56 degrees 37 minutes 10 seconds West 309.05 feet to the point of beginning, containing 2.85 acres, more or less.

Tract 3 (BV Zoning to F Zoning)

A part of the East Half of the West Half of the Northwest Quarter of Section 8, Township 19 North, Range 9 East in Salem Township, Delaware County, Indiana, described as follows:

Commencing at the Southeast corner of the East Half of the West Half of the Northwest Quarter of Section 8, Township 19 North, Range 9 East; thence South 89 degrees 19 minutes 06 seconds West 384.50 feet (assumed bearing) along the South line of said Half-Half-Quarter Section; thence North 00 degrees 36 minutes 18 seconds West 356.94 feet to the point of beginning; thence North 00 degrees 36 minutes 18 seconds West 965.66 feet along the West line of a tract of ground described by Instrument #2024R04722 Records of Delaware County, Indiana to the North line of the South Half of said Half-Quarter Section; thence North 89 degrees 23 minutes 56 seconds East 156.95 feet along said North line to a point 242.00 feet West of the East line of said Half-Quarter Section; thence South 00 degrees 01 minutes 15 seconds West 967.00 feet parallel with said East line to a point that is 355.40 feet North of the South line of said Quarter Section; thence South 89 degrees 53 minutes 57 seconds West 146.39 feet to the point of beginning, containing 3.36 acres, more or less.

Dated: July 26, 2024

PRO FORMA SURVEY

This drawing is not intended to be represented as a retracement or original boundary survey, a route survey, or a Surveyor Location Report.

Haldon L. Ashton

Registered Land Surveyor LS80040149
Haldon L. Ashton

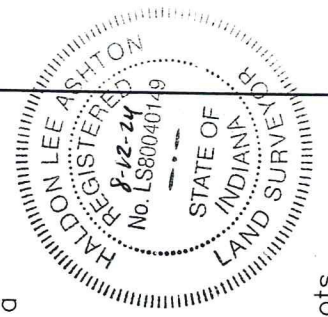

2. Flood Zone:

3. The within tract does partially lie within that Special Flood Hazard Zone A as said tract plots by scale on Community Panel #18035C0306D of the Flood Insurance Rate Maps for Delaware County, Indiana (Maps Dated: 07/04/2011).

4. The minimum flood risk was verified by the INDNR Flood Plain Information Portal—dated: July 26, 2024.

5. Ownership shown herein is per County Records or as indicated in title work provided by others.

This Instrument Prepared by: Haldon L. Ashton
Accuracy or completeness of subsurface features is not certified.

Revisions	
Date:	
Reason:	
Date:	
Reason:	
Drawn: SMK	
Date: 07/02/24	
Job: 2024228 A	
Client: Dan & Karen Ashton	
Owner: Dan & Karen Ashton	
Crew: EA	
Electronic Field Book	

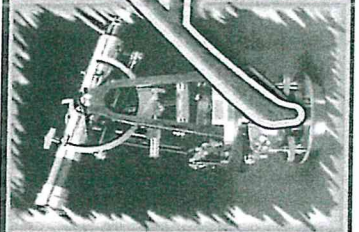

375 West Washington Street Muncie, IN 47305
Ph: (765)282-5594 Fax: (765)282-5594
Email: ashtonlandsurveyors.com

I AFFIRM, UNDER THE PENALTIES FOR PERJURY, THAT I HAVE TAKEN REASONABLE CARE TO REDACT EACH SOCIAL SECURITY NUMBER IN THIS DOCUMENT, UNLESS REQUIRED BY LAW (HALDON L. ASHTON).

REZONING SHEET
STATE ROAD #67
DALEVILLE, IN

SECTION CORNER COORDINATES ARE BASED ON INDIANA STATE PLANE EAST ZONE (NORTH AMERICAN DATUM OF 1983, CORS 96 EPOC 2002.000)